



SCIENCE
CH:7- HOUSING AND CLOTHING

Name: _____

Date: _____

Class: II Sec: _____

I Choose the correct option.

[Clothes , Permanent , Igloo , Kutcha]

- _____ houses cannot be moved from place to place.
- _____ houses are made of mud straw and wood.
- _____ protect our body from heat,cold,wind and rain.
- Eskimos live in _____.

II Fill in the blanks:

- We wear cotton clothes in _____.
- _____ houses are made of bricks and cement.
- House that floats on water is _____.
- _____ roof helps the snow to slide off easily.

III State true or false:

- House boat is found in very cold places. _____
- Kutcha houses are very strong. _____
- Houses in the plains have flat roofs. _____

IV Name the following.

- A permanent house. _____
- A temporary house. _____

V Match the following

Caravans	Winter
Stilt houses	Blocks of ice
Igloo	House on wheels
Woollen clothes	House on poles



INDIAN SCHOOL NIZWA - WORKSHEET

VI Observe the picture and answer the questions.

a. What type of roof does this house have?

b. Where do we find these types of houses?

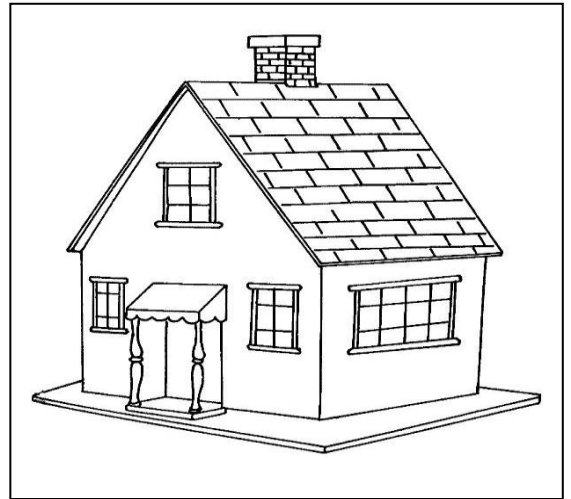

VII Identify the picture and name it



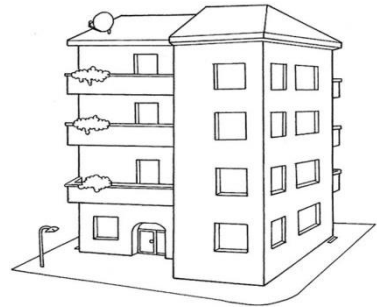



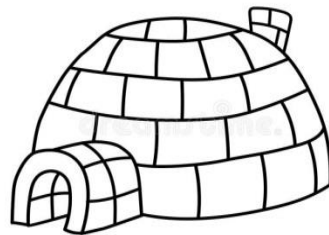



INDIAN SCHOOL NIZWA - WORKSHEET

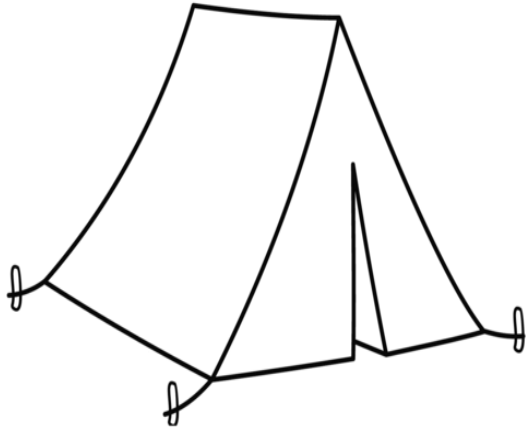



VIII Answer the following.

1. Why should we not find houseboats in Rajasthan?

Ans
